

DIN 2576 Plate Flange, S235JR, DN3000, PN10

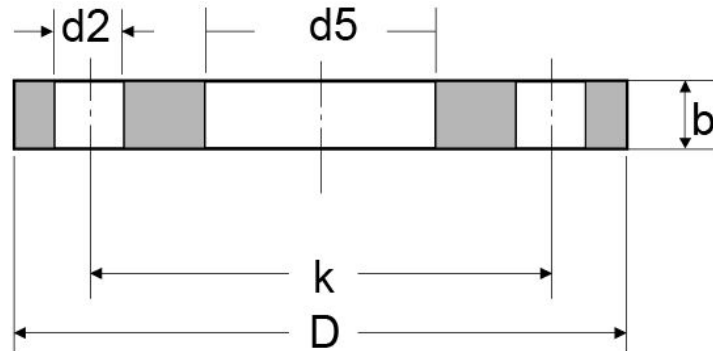

| Nominal Pipe Size | Diameter of Pipe | | Flange Dimension | | | Nuts & Bolts | | | Approx. Flange Weight |
|-------------------|------------------|------|------------------|------------|---------------|--------------------|--------------|-------------------|-----------------------|
| | | | Flange I.D | Flange Dia | Thk of Flange | Dia of Bolt Circle | No. of Holes | Dia of Bolt Holes | |
| DN | ISO | DIN | d5 | D | b | k | | d2 | KG /PCS |
| 10 | - | 14 | 14.5 | 90 | 14 | 60 | 4 | 14 | 0.61 |
| | 17.2 | - | 17.7 | 90 | 14 | 60 | 4 | 14 | 0.6 |
| 15 | - | 20 | 21 | 95 | 14 | 65 | 4 | 14 | 0.67 |
| | 21.3 | - | 22 | 95 | 14 | 65 | 4 | 14 | 0.67 |
| 20 | - | 25 | 26 | 105 | 16 | 75 | 4 | 14 | 0.94 |
| | 26.9 | - | 27.6 | 105 | 16 | 75 | 4 | 14 | 0.94 |
| 25 | - | 30 | 31 | 115 | 16 | 85 | 4 | 14 | 1.13 |
| | 33.7 | - | 34.4 | 115 | 16 | 85 | 4 | 14 | 1.11 |
| 32 | - | 38 | 39 | 140 | 16 | 100 | 4 | 18 | 1.66 |
| | 42.4 | - | 43.1 | 140 | 16 | 100 | 4 | 18 | 1.62 |
| 40 | - | 44.5 | 45.5 | 150 | 16 | 110 | 4 | 18 | 1.89 |
| | 48.3 | - | 49 | 150 | 16 | 110 | 4 | 18 | 1.85 |
| 50 | - | 57 | 58.1 | 165 | 18 | 125 | 4 | 18 | 2.5 |
| | 60.3 | - | 61.1 | 165 | 18 | 125 | 4 | 18 | 2.46 |
| 65 | 76.1 | - | 77.1 | 185 | 18 | 145 | 4 | 18 | 2.99 |
| 80 | 88.9 | - | 90.3 | 200 | 20 | 160 | 8 | 18 | 3.61 |
| 100 | - | 108 | 109.6 | 220 | 20 | 180 | 8 | 18 | 4.17 |
| | 114.3 | - | 115.9 | 220 | 20 | 180 | 8 | 18 | 3.99 |
| 125 | - | 133 | 134.8 | 250 | 22 | 210 | 8 | 18 | 5.66 |
| | 139.7 | - | 141.6 | 250 | 22 | 210 | 8 | 18 | 5.41 |
| 150 | - | 159 | 161.1 | 285 | 22 | 240 | 8 | 22 | 6.97 |
| | 168.3 | - | 170.5 | 285 | 22 | 240 | 8 | 22 | 6.55 |

| | | | | | | | | | |
|-----|-------|-----|-------|-----|----|-----|----|----|-------|
| 175 | 193.7 | - | 196.1 | 315 | 24 | 270 | 8 | 22 | 8.42 |
| 200 | 219.1 | - | 221.8 | 340 | 24 | 295 | 8 | 22 | 9.28 |
| 250 | - | 267 | 270.2 | 395 | 26 | 350 | 12 | 22 | 12.36 |
| | 273 | - | 276.2 | 395 | 26 | 350 | 12 | 22 | 11.85 |
| 300 | 323.9 | - | 327.6 | 445 | 26 | 400 | 12 | 22 | 13.61 |
| 350 | 355.6 | - | 359.7 | 505 | 28 | 460 | 16 | 22 | 20.35 |
| | - | 368 | 372.2 | 505 | 28 | 460 | 16 | 22 | 18.77 |
| 400 | 406.4 | - | 411 | 565 | 32 | 515 | 18 | 26 | 27.52 |
| | - | 419 | 423.7 | 565 | 32 | 515 | 18 | 26 | 35.43 |
| 450 | 457 | - | 462.3 | 615 | 38 | 565 | 20 | 26 | 35.11 |
| 500 | 508 | - | 613.6 | 670 | 38 | 620 | 20 | 26 | 40.2 |
| 600 | 610 | - | 615.5 | 780 | 40 | 725 | 20 | 26 | 51.87 |

Sourcing: <http://www.landeeflange.com/>

Landeeflange.com has won fully trust from clients by providing the best flanges. Our service mission is to achieve 100% customer satisfaction